

# AUREL

## abaco componenti

Le quote dimensionali indicate sono nominali. Nel caso di composizioni che dovranno essere collocate in ambienti particolari, come ad esempio vani chiusi fra due pareti o altro e di cui il cliente avesse necessità di un dimensionamento preciso, è necessario consultare il nostro Customer Service.

### Divano prof. 1060 - 41 3/4"

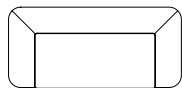

2250 - 88 1/2"

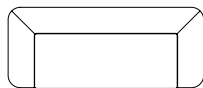

2550 - 100 1/2"

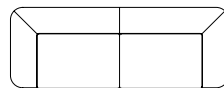

2850 - 112 1/4"

### Elemento terminale prof. 1060 - 41 3/4"

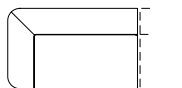

SX  
1700 - 67"

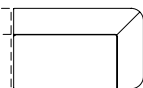

DX

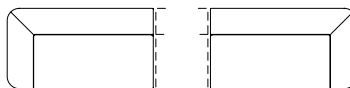

SX  
1900 - 74 3/4"



DX

### Elemento terminale prof. 1060 - 41 3/4"

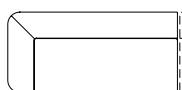

SX  
2200 - 86 1/2"

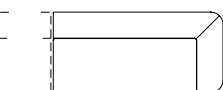

DX

### Elemento terminale inclinato prof. 1600 - 63"

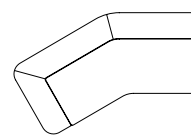

SX  
2450 - 96 1/2"

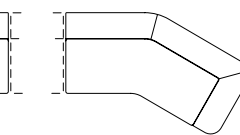

DX

### Elemento centrale prof. 1060 - 41 3/4"

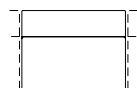

1350 - 53 1/4"

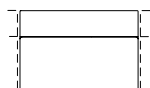

1550 - 61"

### Elemento angolare prof. 1500 - 59"

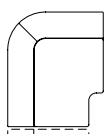

SX  
1250 - 49 1/4"

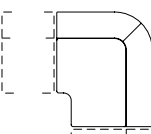

DX

### Elemento angolare inclinato prof. 1500 - 59"

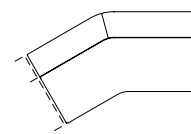

SX  
2200 - 86 1/2"

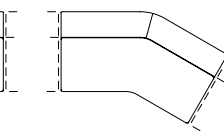

DX

### Dormeuse terminale prof. 1800 - 70 3/4"

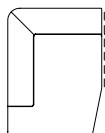

SX  
1250 - 49 1/4"

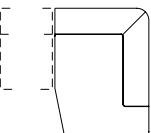

DX

### Dormeuse terminale prof. 2100 - 82 3/4"

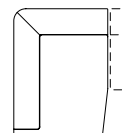

SX  
1250 - 49 1/4"

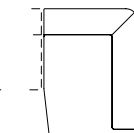

DX

### Dormeuse terminale inclinata prof. 1850 - 72 3/4"

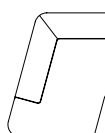

SX  
1700 - 67"

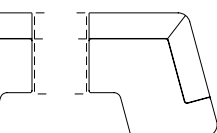

DX

### Cuscino schienale



680 x 680  
26 3/4" x 26 3/4"

### Cuscino decorativo



500 x 500  
19 1/2" x 19 1/2"